

# SDX STAINLESS STEEL TERMINAL BOXES

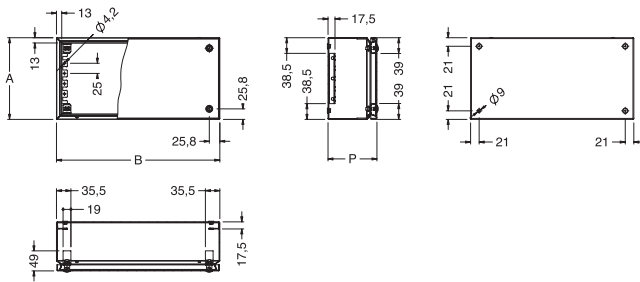

## CHARACTERISTICS

Boxes and door manufactured from 12/10 AISI 304L stainless steel (AISI 316L on request).

Lid fixing with stainless steel screws.

Holes for fixing the hinges.

## CONFORMITY AND APPROVAL



## PROTECTION RATINGS

- IP 66 complying with IEC EN62208; EN60529
- NEMA 4X complying with UL508A; UL50
- impact resistance IK10 complying with IEC EN62208; EN50102.

## STAINLESS STEEL TERMINAL BOXES

SDX CODE	DIMENSIONS		
	B	A	P
SDX1-108	150	150	80
SDX2-208	200	200	80
SDX3-208	300	200	80
SDX1-112	150	150	120
SDX4-212	400	200	120
SDX3-312	300	300	120

To be ordered separately:

- mounting plate and/or DIN rails (for DIN rails see page 153).

To order a stainless steel enclosure in high grade AISI 316L, add the suffix "H" to the code.

I.E.: SDX1-108H.

## MOUNTING PLATE

SDPA CODE	BOX DIMENSIONS		B	A	WEIGHT KG.
	WIDTH	HEIGHT			
SDPA-11	150	150	140	140	0.45
SDPA-22	200	200	176	170	0.59
SDPA-32	300	200	276	170	0.92
SDPA-33	300	300	276	270	1.46
SDPA-42	400	200	376	170	1.26

## MOUNTING PLATE SDPA



Manufactured from 2mm sendzimir sheet steel.  
Supply includes: single piece.